

## SERVICE SCHEDULE

### Maintenance Intervals

Maintenance work must be done at regular intervals. Failure to do so will result in excessive wear and early failures.

The service schedule is a guide for correct maintenance of the Bobcat excavator.

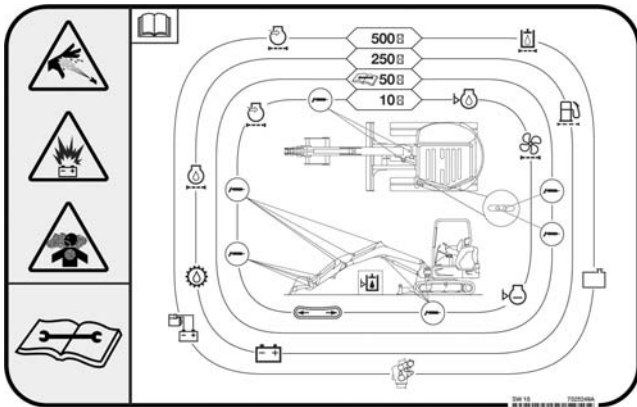

See inside page of the back cover for symbols and identification.

#### *Every 10 Hours (Before Starting The Excavator)*

- **Engine Oil** - Check level and add as needed. (See Page 117.)
- **Engine Air Filters and Air System** - Check condition indicator. Service only when required. Check for leaks and damaged components. (See Page 110.)
- **Engine Coolant** - Check coolant level COLD and add premixed coolant as needed. (See Page 119.)
- **Seat Belt, Seat Belt Retractors, Seat Belt Mounting hardware** - Check the condition of seat belt and mounting hardware. Clean or replace seat belt retractors as needed. Clean dirt and debris from moving parts. (See Page 103.)
- **Motion Alarm and Horn** - Check for proper function (if equipped). (See Page 104.)
- **Control Console Lockout** - Check the control console lockout lever for proper operation. (See Page 102.)
- **Operator Canopy / Cab** - Check the canopy / cab condition and mounting hardware. (See Page 37.)
- **Operator Cab and Heater Filters** - Clean filters. (See Page 108.)
- **Indicators and Lights** - Check for correct operation of all indicators and lights. (See Page 32.)
- **Safety Signs** - Check for damaged signs (decals). Replace any signs that are damaged. (See Page 17.)
- **Hydraulic Fluid** - Check fluid level and add as needed. (See Page 128.)
- **Track Tension** - Check tension and adjust as needed. (See Page 132.)
- **Pivot Points** - Grease all machinery pivot points. Grease clamp (if equipped). (See Page 139.)
- **Attachment Coupler** - Check for damage or loose parts (if equipped). (See Page 137.)
- **Fuel Filter** - Drain water and sediment. (See Page 114.)

#### *First 50 Hours*

- **Fuel Filter** - Change filter. (See Page 114.)
- **Engine Oil and Filter** - Replace oil and filter. (See Page 117.)
- **Drive Belts (Alternator)** - Check condition. Replace as needed. (See Page 135.)
- **Hydraulic Filter and Case Drain Filter** - Replace the hydraulic filter and the case drain filter. (See Page 129.)
- **Alternator and Starter** - Check connections.
- **Travel Motors (Final Drive)** - Replace fluid. (See Page 134.)

#### *Every 50 Hours*

- **Swing Bearing** - Grease swing bearing and swing pinion. Service every 10 hours when operating in water. (See Page 139.)

**! WARNING**

#### **AVOID INJURY OR DEATH**

**Instructions are necessary before operating or servicing machine. Read and understand the Operation & Maintenance Manual, Operator's Handbook and signs (decals) on machine. Follow warnings and instructions in the manuals when making repairs, adjustments or servicing. Check for correct function after adjustments, repairs or service. Untrained operators and failure to follow instructions can cause injury or death.**

W-2003-0807

## SERVICE SCHEDULE (CONT'D)

### Maintenance Intervals (Cont'd)

*Every 100 Hours*

- **Spark Arrester** - Empty spark chamber. (See Page 131.)

*Every 250 Hours Or Every 12 Months*

- **Battery** - Check cables and connections. (See Page 121.)
- **Fuel Filter** - Change fuel filter and pre-filter. (See Page 114.)
- **Travel Motors (Final Drive)** - Check fluid level and add as needed. (See Page 134.)
- **Engine Oil and Filter** - Replace oil and filter. (See Page 117.)

*Every 500 Hours Or Every 12 Months*

- **Engine Air Filters and Air System** - Check condition indicator. Service only when required. Check for leaks and damaged components. (See Page 110.)
- **Engine Cooling System** - Clean debris from radiator, fuel cooler and hydraulic fluid cooler. (See Page 119.)
- **Drive Belts (Alternator)** - Check condition. Replace as needed. (See Page 135.)
- **Hydraulic Filter, Hydraulic Fluid, Case Drain Filter and Hydraulic Reservoir Breather Cap** - Replace the hydraulic filters and fluid. (See Page 129.)
- **Alternator and Starter** - Check connections.
- **Consult Engine Owner's Manual.**

*Every 1000 Hours Or Every 12 Months*

- **Engine Valves** - Adjust the engine valve clearance.

*Every 24 Months*

- **Coolant** - Replace the coolant. (See Page 120.)

### Inspection Checkbook

Maintenance work must be done at regular intervals. Failure to do so will result in excessive wear and early failures

The service schedule is a guide for the correct maintenance of the Bobcat excavator.

The Inspection Checkbook contains the following information:

- Doosan Bobcat EMEA s.r.o. Warranty Policy
- Doosan Bobcat EMEA s.r.o. Extended Warranty Policy

The inspection checkbook has to be filled in by the Dealer for any maintenance and service work of your Bobcat machine. This book may be required anytime by an authorised dealer or by Bobcat Europe, should be a breakdown occur on the Bobcat equipment.

Your dealer can order the Inspection Checkbook.  
Part Number: 7296478.