

SERVICE SCHEDULE

EVERY 8-10 HOURS

Check engine coolant level. Add pre-mixed coolant as needed.
 Check engine oil level.
 Check hydraulic oil level.
 Check and adjust track tension as needed.
 Check indicator lights for correct operation.
 Check canopy condition and mounting hardware.
 Check seat belt condition, retractor and mounting hardware.
 Check for damaged signs (decals) and safety tread - Replace any signs (decals) and safety tread that are damaged or worn.
 Grease all machinery pivot points with multi-purpose lithium based grease. (See illustrations)
 Check control lockout lever for proper operation.
 Check for leaks and/or tightness of pipes, hoses, control unit, hydraulic pumps, cylinders, etc.
 Check water separator. Drain and clean element if required.
 Check and empty air cleaner dust cap as needed, check air system for leaks.

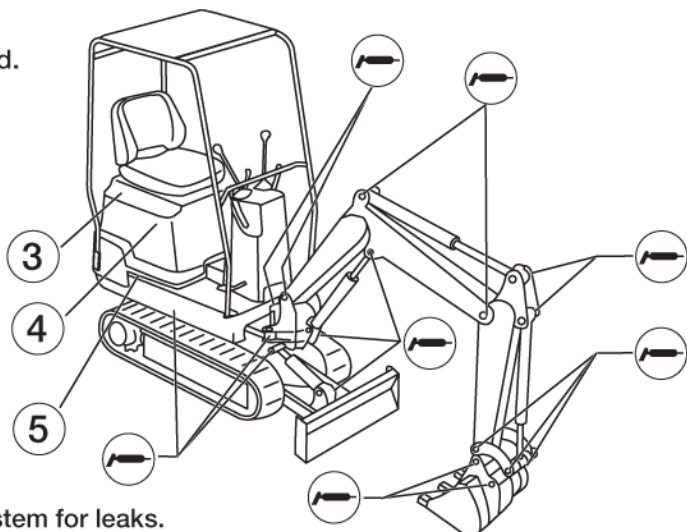

EVERY 50 HOURS

Grease swing pinion and swing circle.
 Check radiator fins and clean using pressurized air/water if required.
 Check battery, cables, connections and electrolyte level. Add distilled water as needed.

EVERY 100 HOURS

- Check condition of alternator/fan belt and adjust as needed.
 Check fuel filter and clean if required.
 Check air filter and replace if required.
- Replace engine oil and filter.
 Empty spark chamber on spark arrestor muffler. (If equipped)

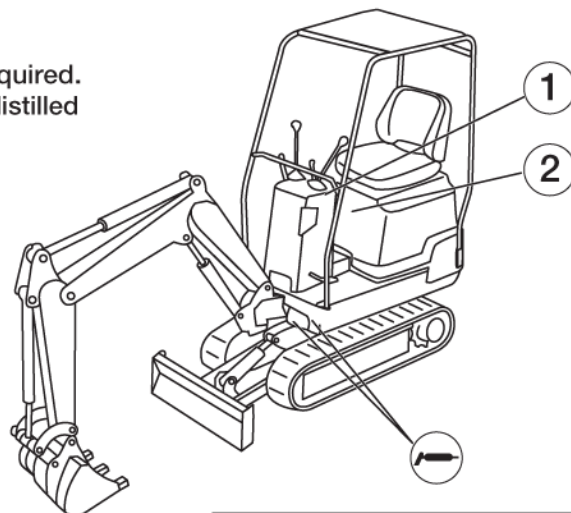

EVERY 250 HOURS

Check oil level in both final drive cases. Add oil if needed.
 Drain sediment and water from hydraulic oil tank. Add hydraulic oil as needed.
 Drain sediment and water from fuel tank and clean fuel tank strainer.





EVERY 500 HOURS

- ▲ Replace fuel filter.
- ▲ Replace hydraulic oil filter.
 Check and adjust engine valve clearance.
 Drain and flush cooling system - Replace coolant.
- †▲ Clean hydraulic oil tank suction filter. Replace strainer if damaged.

EVERY 1000 HOURS OR EVERY 6 MONTHS

- ◆ Replace oil in both final drive cases.
 Replace hydraulic oil and filter-clean hydraulic oil tank.
- Service at first 50 hours, then as scheduled.
- ▲ Service at first 100 hours, then as scheduled.
- † Replace every 2000 hours.
- ◆ Replace at first 250 hours, then as scheduled.

FILTER CHART

1. 	AIR FILTER	19167-1108-0
2. 	ENGINE OIL FILTER	15841-32430-0
3. 	FUEL FILTER	15231-4356-0
4. 	HYDRAULIC OIL FILTER	12514-1102
5. 	HYDRAULIC OIL TANK SUCTION FILTER	NTS2-22001

• See illustrations above for filter locations.